

SUPPLY OF MATERIALS, LABOR, AND INSTALLATION OF GLASS PARTITION, ONE SWING AND ONE SLIDING DOOR, AND ONE TRANSACTION WINDOW AT NICU AS HUMAN MILK BANK STATION

Below shall be the scope of work:

1. Fenestration Works

Specific work shall be the following:

1. Mobilization/demobilization of equipment, material, manpower and to the site including clearing of all waste or debris generated during the entire construction duration.
2. Observe Safety and Health of the project and its manpower and equipment.
3. Fabrication and Installation of one (1) unit (D-01) 1.00m x 2.10m Single Leaf Swing Glass Door on Powder Coated Aluminum Frame with 6mm thick Clear Glass, complete accessories, hardware and all necessary needed support.
4. Fabrication and Installation of one (1) unit (D-02) 1.00m x 2.10m Single Leaf Hanging Sliding Glass Door on Powder Coated Aluminum Frame with 6mm thick Clear Glass, complete accessories, hardware and all necessary needed support.
5. Fabrication and Installation of one (1) unit (W-01) 1.80mx1.20m Fixed and Sliding Transaction Window on Glass Powder Coated Aluminum Framing with 6mm thick Clear Glass, complete accessories, hardware and all necessary needed supports
6. Fabrication and Installation of (Glass Partition) 16.55sq.m. Fixed Glass Partition on Powder Coated Aluminum Frame with 6mm thick Clear Glass with complete accessories, hardware and all necessary needed supports.
7. See attached drawing for reference.
8. All areas that have been affected or damaged must be restored to be functional and acceptable state.
9. All works of the project must be accomplished within the **14 Calendar Days**.

Note:

1. Site inspection shall be conducted with the R2TMC Engineers prior to submission of proposal.
2. Certificate of Site Inspection from Engineering and Facility Management shall be attached together with the proposal.
3. All workmanship shall be subjected to inspection, examination and testing by the R2TMC Engineer-in-charge of the project. The R2TMC Engineer-in-charge of the project shall have the right to reject defective materials and workmanship or require its correction.
4. All items not specifically mentioned in the Scope of Work but which are obviously necessary to make a complete working installation shall be included.
5. Payment shall be process after all works has been satisfactorily completed.

Republic of the Philippines
 Center for Health and Development No. 02
 REGION II TRAUMA AND MEDICAL CENTER
 AH26, Magaysay, Bayombong, Nueva Vizcaya



Project Name: SUPPLY OF MATERIALS, LABOR, AND INSTALLATION OF GLASS PARTITION, ONE SWING AND ONE SLIDING DOOR, AND ONE TRANSACTION WINDOW AT NICU AS HUMAN MILK BANK STATION
 Project Location: Region II Trauma and Medical Center, Magaysay, Bayombong, Nueva Vizcaya
 Subject: PROGRAM OF WORKS

Item No.	Description	Qty	Unit	Material Cost	Labor Cost	Equipment Cost	Estimated Direct Cost	Mark-ups (%)	Total Mark-up %	Total Mark-up Value	VAT=5%(EDC+OCM+Profit)	Total Indirect Cost	Total Cost	Unit Cost
1 FENESTRATION:														
Labor, Materials and Installation:														
	(D-01) 1.00m x 2.10m Single Leaf Swing Glass Door on Powder Coated Aluminum Frame with 6mm thick Clear Glass, complete accessories, hardware and all necessary needed supports. (Includes materials, labor, and installation)	1.00	set											
	(D-02) 1.00m x 2.10m Single Leaf Hanging Sliding Glass Door on Powder Coated Aluminum Frame with 6mm thick Clear Glass, complete accessories, hardware and all necessary needed supports. (Includes materials, labor, and installation)	1.00	set											
	(W-01) 1.80m x 1.20m Fixed and Sliding Transaction Window on Glass Powder Coated Aluminum Framing with 6mm thick Clear Glass, complete accessories, hardware and all necessary needed supports. (Includes materials, labor, and installation)	1.00	set											
	(Glass Partition) 26.55 sq.m. Fixed Glass Partition on Powder Coated Aluminum Frame with 6mm thick Clear Glass with complete accessories, hardware and all necessary needed supports. (Includes materials, labor, and installation)	1.00	lot											
	Sub-Total													
TOTAL PROJECT COST														
PHP														

Submitted by:

Name & Signature of Bidder/Supplier

Republic of the Philippines Center for Health Development, Inc.		PREPARED BY AR EDSAL C. LANSAY		CONSUMED BY DANIL ORNELA A. BALANT AND DIPS		PROJECT TITLE SUPPLY OF MATERIALS, LABOR, AND INSTALLATION OF ELECTRICAL WORKS AT MILK AS HUMAN MILK BANK STATION		CLIENT ENGR. CHARLES A. VERMOSO, JR.		PROJECT MANAGER APPROVAL ENGR. JAMES A. GAMBAYAN		APPROVAL RAY P. STANDING		SHEET CONTENT AS SHOWN		SHEET A-1	
REGION II TRAUMA & MEDICAL CENTER Beroeng, New Victoria, Philippines 7100 Tel No. (078) 800-3489 Fax No. (078) 800-3501		ADMINISTRATIVE ASSISTANT III		REGIONAL CHIEF		REGION II TRAUMA AND MEDICAL CENTER		REGION II		REGIONAL CHIEF II		MEDICAL CENTER CHIEF II		AS SHOWN		A-1	

MILK BANK FLOOR PLAN

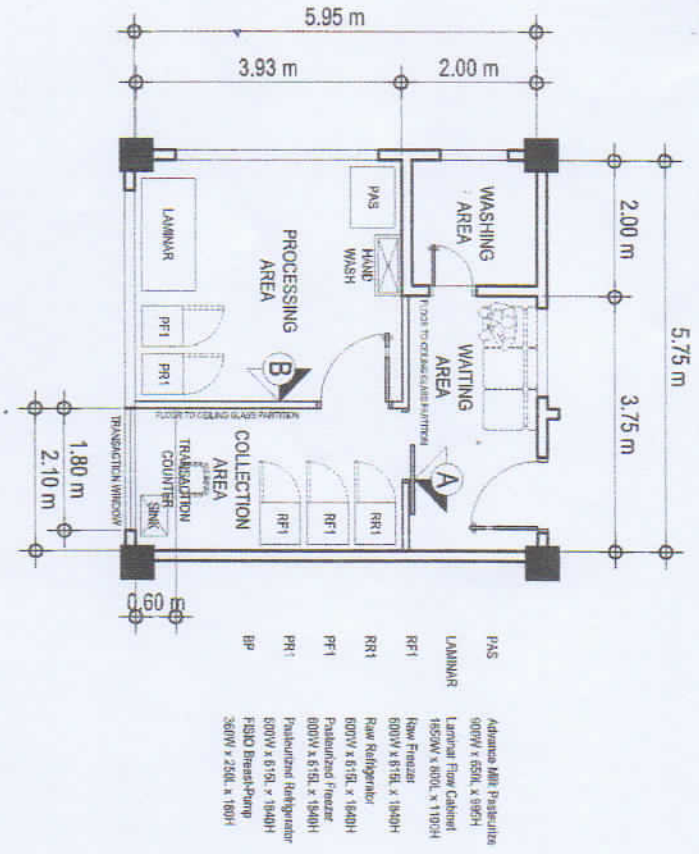

SECTION "A"

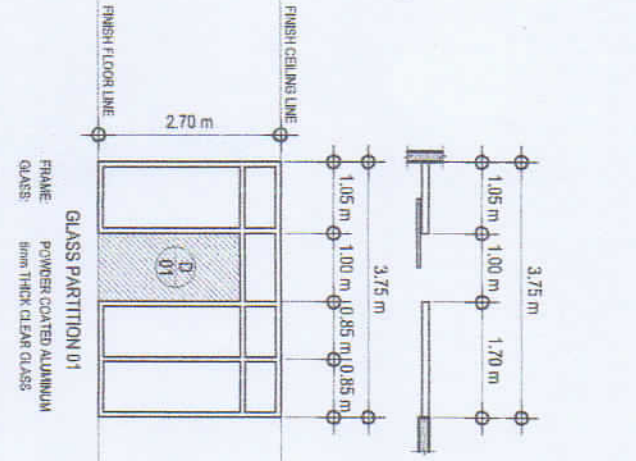

SECTION "B"

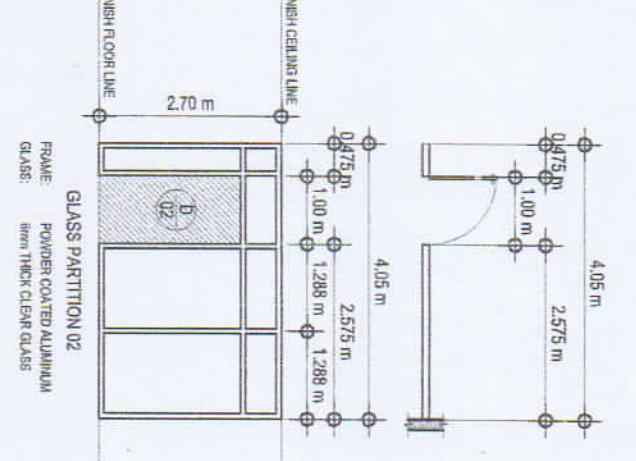

- DESCRIPTION:** HANGING SLIDING GLASS DOOR ON POWDER COATED ALUMINUM FRAME WITH DOOR JAMB, DOOR HANDLE, COMPLETE HARDWARE AND ACCESSORIES
GLASS: 6mm THICK CLEAR GLASS
- DESCRIPTION:** HANGING SLIDING GLASS DOOR ON POWDER COATED ALUMINUM FRAME WITH DOOR JAMB, DOOR HANDLE, COMPLETE HARDWARE AND ACCESSORIES
GLASS: 6mm THICK CLEAR GLASS
- DESCRIPTION:** FIXED AND SLIDING TRANSECTION WINDOW WITH COMPLETE HARDWARE AND ACCESSORIES
GLASS: 6mm THICK CLEAR GLASS

SCHEDULE OF DOORS AND WINDOWS

